

Combination Switch (Light)

LIGHTING SYSTEM

12. Combination Switch (Light)

A: REMOVAL

CAUTION:

Before handling the airbag module, refer to “CAUTION” of “General Description” in “AIRBAG SYSTEM”. <Ref. to AB-9, CAUTION, General Description.>

- 1) Set the tire to the straight-ahead position.
- 2) Disconnect the ground cable from battery and wait for at least 60 seconds before starting work. <Ref. to NT-5, BATTERY, NOTE, Note.>

NOTE:

For models other than STI model, disconnect the ground terminal from battery sensor.

- 3) Remove the driver's airbag module. <Ref. to AB-33, REMOVAL, Driver's Airbag Module.>
- 4) Remove the steering wheel. <Ref. to PS-16, REMOVAL, Steering Wheel.>
- 5) Remove the cover assembly - column.
 - (1) Release the clips, and remove the cover assembly - steering UPR.
 - (2) Remove the screws.
 - (3) Remove the cap - key cylinder (a). (Model with keyless access)
 - (4) Release the claw, and remove the cover assembly - column UPR and the cover assembly - column LWR.

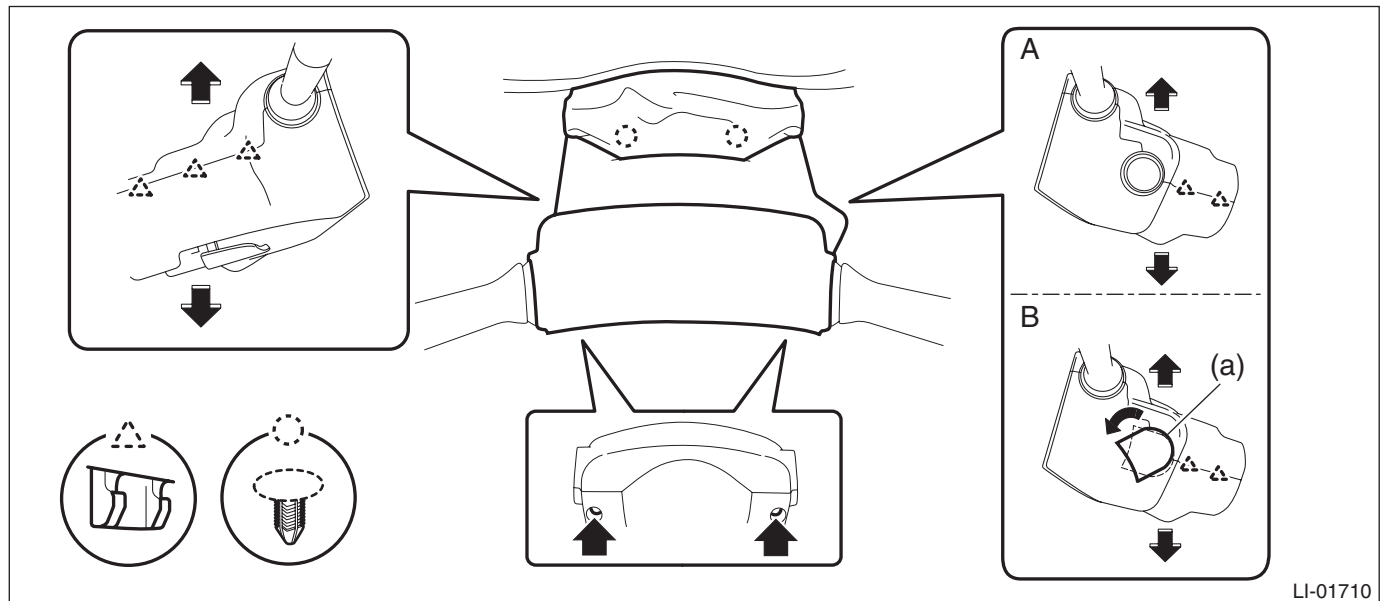

A Keyless entry model

B Keyless access model

6) Remove the steering roll connector. <Ref. to AB-60, REMOVAL, Roll Connector.>

7) Remove the combination switch (wiper). <Ref. to WW-8, REMOVAL, Combination Switch (Wiper).>

- 8) Remove the switch assembly - combination turn dimmer.
- (1) Disconnect the connector.
 - (2) Using pliers, loosen the clamp.
 - (3) With the clamp loosened, release the claw using a flat tip screwdriver, and remove the switch assembly - combination turn dimmer.

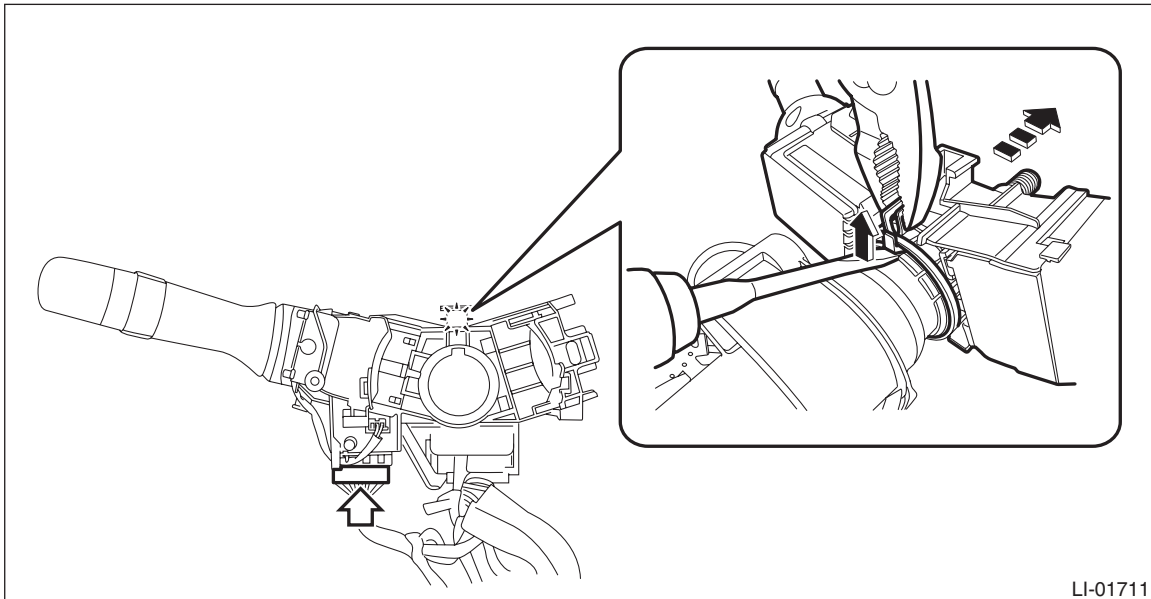

B: INSTALLATION

CAUTION:

- Before handling the airbag module, refer to “CAUTION” of “General Description” in “AIRBAG SYSTEM”. <Ref. to AB-9, CAUTION, General Description.>
- Do not allow harness and connectors to interfere or get tangled up with other parts.
- If the steering wheel and steering angle sensor (steering roll connector) are removed, perform “VDC sensor midpoint setting mode” of the VDC. <Ref. to VDC-16, VDC SENSOR MIDPOINT SETTING MODE, ADJUSTMENT, VDC Control Module and Hydraulic Control Unit (VDCCM&H/U).>

- 1) Install the switch assembly - combination turn dimmer.
- 2) Install the combination switch (wiper).
- 3) Install the steering roll connector. <Ref. to AB-61, INSTALLATION, Roll Connector.>
- 4) Install the cover assembly - column.
- 5) Install the steering wheel.

Tightening torque:

39 N·m (4.0 kgf-m, 28.8 ft-lb)

Clearance:

Between cover assembly - column and steering wheel: 4 — 6 mm (0.16 — 0.24 in)

- 6) Install the driver’s airbag module. <Ref. to AB-34, INSTALLATION, Driver’s Airbag Module.>
- 7) Connect the battery ground terminal. <Ref. to NT-5, BATTERY, NOTE, Note.>

NOTE:

For models other than STI model, connect the ground terminal to battery sensor.

Combination Switch (Light)

LIGHTING SYSTEM

C: INSPECTION

1) Measure the resistance between connector terminals.

Preparation tool:

Circuit tester

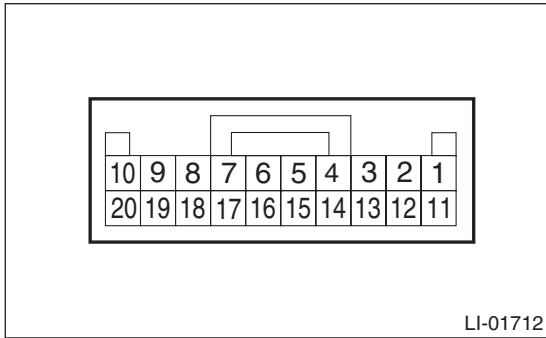

- Lighting switch

Terminal No.	Inspection conditions	Standard
18 — 12 19 — 12 20 — 12	Switch OFF	1 MΩ or more
19 — 12	Switch AUTO	Less than 1 Ω
18 — 12	Switch 1 (TAIL)	Less than 1 Ω
18 — 12 20 — 12	Switch 2 (HEAD)	Less than 1 Ω

- Dimmer & passing switch

Terminal No.	Inspection conditions	Standard
11 — 12 17 — 12	Switch PASS	Less than 1 Ω
11 — 12	Switch UP	Less than 1 Ω

- Turn signal switch

Terminal No.	Inspection conditions	Standard
13 — 12	Switch TURN (RH)	Less than 1 Ω
15 — 12	Switch TURN (LH)	Less than 1 Ω

- Front fog light switch

Terminal No.	Inspection conditions	Standard
4 — 3	Switch OFF	1 MΩ or more
	Switch ON	Less than 1 Ω

2) Replace the switch assembly - combination turn dimmer if the inspection result is not within the standard value.